



Custom Dynamics® Handlebar Extension Wire Kit Installation Instructions

We thank you for purchasing the Custom Dynamics® Handlebar Extension Wire Harness. Our products utilize the latest technology and high quality components to ensure you the most reliable service. We offer one of the best warranty programs in the industry and we back our products with excellent customer support, if you have questions before or during installation of this product please call Custom Dynamics® at 1(800) 382-1388.

Part Numbers: CD-BAR-EXT-6

Package Contents:

- 4" Handlebar Extension Wire Harnesses (2)
- Instructions (1)

Fits: 2011-2024 Harley-Davidson® Softail models, 2012-2017 Dyna models and 2014- 2022 Sportster XL models, 2014-2024 Ultra Limited (FLHTK), 2014-2023 Street Glide (FLHX), Street Glide Special (FLHXS), 2015-2023 Road Glide (FLTRX), Road Glide Special (FLTRXS), 2017-2025 Road King Special (FLHRXS), 2014-2022 Road King (FLHR), 2022-2023 Street Glide ST (FLHXST), Road Glide ST (FLTRXST) & CVO™ Road Glide Limited (FLTRKSE), 2020-2024 Road Glide Limited (FLTRK), 2015-2022 CVO™ Street Glide (FLHXSE), 2018-2022 CVO™ Road Glide (FLTRXSE), 2019-2022 Electra Glide Standard (FLHT), 2014-2019 Electra Glide Ultra Classic (FLHTCU), 2015-2016 Ultra Classic Lo (FLHTCUL) & CVO™ Road Glide Ultra (FLTRUSE), 2016-2019 Road Glide Ultra (FLTRU), 2015-2018 Ultra Limited Lo (FLHTKL), 2014-2021 CVO™ Limited (FLHTKSE), 2014 CVO™ Road King (FLHRSE), 2014-2025 Tri Glide (FLHTCUTG), 2020-2022 CVO™ Tri Glide (FLHTCUTGSE), 2015-2025 Freewheeler (FLRT), and 2023-2025 Road Glide 3 (FLTRT).



Installation:

1. Disconnect the negative battery cable from the battery.
2. Locate electrical connectors under the gas tank. Removal or repositioning of the gas tank will be necessary for this installation. Refer to service manual for specific instructions.
3. Disconnect both the 4-position JAE handle bar connectors and the 2-position JAE kill switch connector from the bikes harness by pressing on the tab on the male connector to release. Shown in **Figure 1**. The two position JAE is the kill switch for the right side hand control and will be located close to the 4-position JAE under the gas tank.

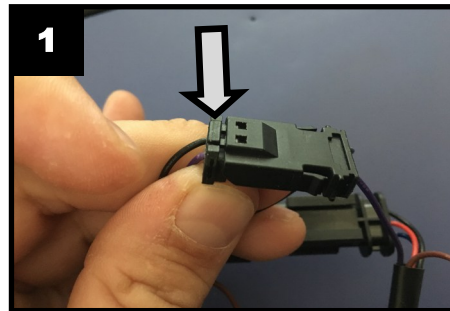

4. Plug the handlebar extension into each hand control harness. Route each side harness down the handlebars towards the bikes harness under the gas tank. The JAE connectors are normally small enough to route internally on most handlebars. (Do NOT cut and solder CAN BUS wiring).
5. Connect both left and right control harness and the two position kill switch connector to the motorcycles main harness.
6. Reinstall any parts that were removed to access the electrical connections.
7. Reconnect electrical connections and fuel lines for the gas tank and tighten all hardware to secure the tank.
8. Reconnect the negative battery cable to the battery.
9. Test all controls for proper operation.



ATTENTION

Please read all Information below before Installation

Warning: Disconnect negative battery cable from battery; refer to owner's manual. Failure to do so may result in electrical shock, injury, or fire. Secure negative battery cable away from positive side of battery and all other positive voltage sources on motorcycle.

Safety First: Always wear appropriate safety gear including safety glasses when performing any electrical work. It is highly recommended that safety glasses be worn throughout this installation process. Be sure motorcycle is on level surface, secure and cool.

Important: Motorcycle should be secured on a level surface for installation.

Questions? Email: info@CustomDynamics.com or Call us at: 1 (800) 382-1388 M-TH 8:30AM-5:30PM / FR 9:30AM-5:30PM EST