



Custom Dynamics® Road Glide LED Windshield Trim Installation Instructions

We thank you for purchasing the Custom Dynamics® Road Glide LED Windshield Trim. Our products utilize the latest technology and highest quality components to ensure you the most reliable service. We offer one of the best warranty programs in the industry and we back our products with excellent customer support, if you have questions before or during installation of this product please call Custom Dynamics® at 1 (800) 382-1388.

Part Numbers: CD-RG-SWT-AW2-B CD-RG-SWT-AW2-C
CD-RG-WT-AW2-B CD-RG-WT-AW2-C
CD-RG-WTSEQ-15-B CD-RG-WTSEQ-15-C

Package Contents:

- LED Windshield Trim Assemblies (2)
- Wiring Harness (2)
- 10-32 Button Head Cap Screws (4)
- Washers: Large Metal (4), Small Metal (4), Rubber (4)
- Instructions (1)

Fitment: 2015-2023 Harley-Davidson® Road Glide (FLTRX), Road Glide Special (FLTRXS), 2022-2023 Road Glide ST (FLTRXST) and CVO™ Road Glide Limited (FLTRKSE), 2020-2024 Road Glide Limited (FLTRK), 2018-2022 CVO™ Road Glide (FLTRXSE), 2016-2019 Road Glide Ultra (FLTRU), 2020-2022 CVO™ Road Glide Ultra (FLTRUSE) and 2023-2025 Road Glide 3 (FLTRT).



Installation:

1. Remove and discard the 4 OEM windshield screws, they will not be reused. Remove windshield and set aside in a safe place to prevent damage. Shown in **Figure 1**.



2. Remove the top vent, it is secured with retaining clips. Position yourself in front of the motorcycle and lift straight up on the top vent and release it from the retaining clips and set aside in a safe place to prevent damage. Shown in **Figure 2**.



Please read all Information below before Installation

Warning: Disconnect negative battery cable from battery; refer to owner's manual. Failure to do so may result in electrical shock, injury, or fire. Secure negative battery cable away from positive side of battery and all other positive voltage sources on motorcycle.

Safety First: Make sure the motorcycle is parked on a level surface and motorcycles mechanical components are cool to the touch.

Notice: This product is designed and intended for use as auxiliary lighting on motorcycles only. This product is NOT intended to replace any original equipment lighting installed on the motorcycle and should not be used for that purpose. This product must be wired in such a fashion that it does not interfere with any original equipment lighting.

Note: You will have to remove the front fairing dash and windshield in order to complete this installation. Please refer to your manufacturer's service manual if unsure of this procedure.

Cleaning: Take special care in cleaning the finish. Never use abrasive polishes or cleaners as these can scratch and/or damage the finish. Avoid power washing/ applying direct stream to aftermarket parts.

Note: Failure to use the supplied mounting hardware will void all warranties.

Note: Over-tightening the mounting hardware will cause the paint to chip which is not covered under the warranty.

Note: Hand start all bolts, **DO NOT** use impact wrench/"zip gun" when installing.

Questions? Email: info@CustomDynamics.com or Call us at: 1 (800) 382-1388 M-TH 8:30AM-5:30PM / FR 9:30AM-5:30PM EST

Installation Instructions - Page 2

Installation Continued:

3. Connect the left and right Custom Dynamics® Road Glide LED Windshield Trim with Wiring Harnesses installed, in-line to the left and right JAE Connectors on the motorcycle. Shown in **Figures 3, 4 and 5.**

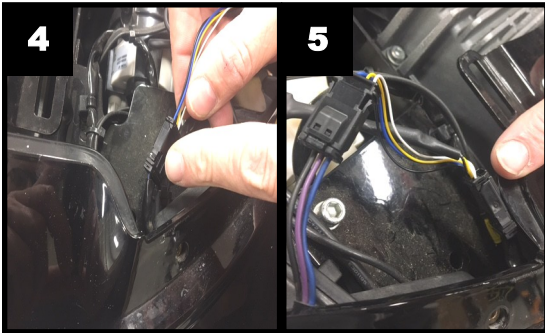

4. Route the Custom Dynamics® Road Glide LED Windshield Trim Wiring Harnesses on both left and right sides towards the inner fairing. You will notice a small gap at the point where the inner fairing and outer fairing and windshield will fit together, the wire will exit here and the excess wire secure with Cable Ties to prevent them from being cut, frayed or pinched. Shown in **Figures 6 and 7.**

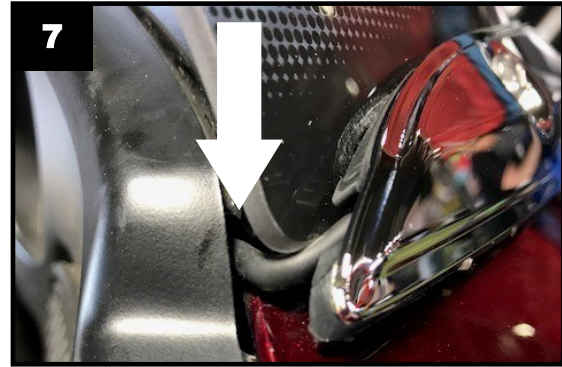

5. Reinstall top vent by pressing back down into the retaining clips. **Note: When reinstalling the top vent be careful not to pinch the LED Windshield Trim Wiring Harness.**
6. Install the new Custom Dynamics® Road Glide LED Windshield Trim using the supplied 10-32 Button cap Screws and Washers. Washer order is **Large Washer, Small Washer, Rubber Washer.** Shown in **Figure 8.** **Note: Hand start all bolts, DO NOT use impact wrench/"zip gun" when installing.**

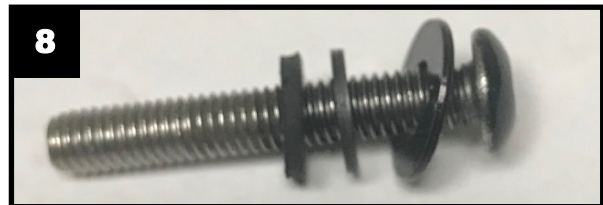

7. Test the Custom Dynamics® Road Glide LED Windshield Trim for proper operation. **Note: If you're experiencing a Rapid Flash on your dash indicators you will need to do a BCM Sync. To perform a BCM Sync turn ignition ON and turn on the 4 way hazards and count 10 flashes and deactivate. Turn on 4 way hazards for another 10 flashes and deactivate. Turn ignition OFF then back ON and turn 4 way hazards on for 10 flashes and deactivate. After performing the BCM Sync the dash indicators should no longer be Rapid Flashing.**