



Custom Dynamics® Tribar 2 Eliminator Harness Installation Instructions

We thank you for purchasing the Custom Dynamics® Tribar Eliminator Harness. Our products utilize the latest technology and high quality components to ensure you the most reliable service. We offer one of the best warranty programs in the industry and we back our products with excellent customer support, if you have questions before or during installation of this product please call Custom Dynamics® at 1(800) 382-1388.

Part Numbers: CD-TRI2-ELIM-HARN

Package Contents:

-Tribar Eliminator Harness (1)

Fits: 2010-2013 US Model Harley-Davidson® Street Glide® and Road Glide® Custom



Please read all Information below before Installation

Warning: Disconnect negative battery cable from battery; refer to owner's manual. Failure to do so may result in electrical shock, injury, or fire. Secure negative battery cable away from positive side of battery and all other positive voltage sources on vehicle.

Safety First: Always wear appropriate safety gear including safety glasses when performing any electrical work. It is highly recommended that safety glasses be worn throughout this installation process. Be sure vehicle is on level surface, secure and cool.

Important: This product is designed and intended for use as auxiliary lighting only. It is NOT intended to replace any original equipment lighting installed on the vehicle and should not be used for that purpose. This product must be wired so that it does not interfere with any original equipment lighting.

Note: Removal of OEM TriBar light requires additional run, brake, turn module or Custom Dynamics® SMART Triple Play® (sold separately). Signal Stabilizer™ may also be required if not already installed (sold separately). In addition, this configuration is not compatible with "red ring" style rear turn signals; only use with solid red rear turn signal configurations like our Genesis® 4 Solid Red 1157 Rear Turn Signals (sold separately).

Installation:

1. Remove seat and disconnect negative battery cable.
2. Remove the black cover on the back side of the tribar light.
3. Unplug the connectors from both sides of the tribar by lifting the tabs to disconnect. Refer to picture 1.

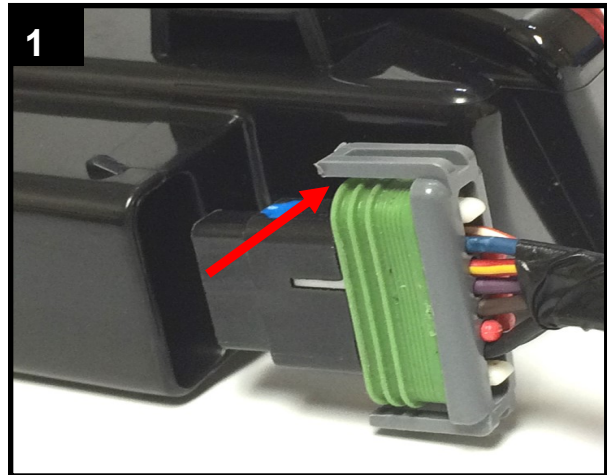

4. Remove the 2 Torx T25 screws that hold the stock tribar assembly in place.
5. Slowly pull the tribar away from the fender, making sure that the wiring and connectors are free as well. Once removed, discard.
6. Plug the harness connectors into the Tribar Eliminator Harness noting the **Input** and **Output** labeled connectors. Left side Input is coming from the bike, the right side is the output to the turn signals. Make sure that the connector orientation is correct going into the ports, they are keyed one way, if the connector does not want to snap in, flip it around and try it again. Do not force the connector into the port.
7. Secure the Tribar Eliminator Harness from getting damaged or frayed by the back tire.
8. Reconnect the negative battery cable to the battery and reinstall the seat.
9. Test operation of all lighting for proper running, brake and turn before riding.

Questions? Call us at: 1 (800) 382-1388 M-TH 8:30AM-5:30PM / FR 9:30AM-5:30PM EST