



Custom Dynamics® Saddlebag Grommet Installation Instructions

We thank you for purchasing the Custom Dynamics® Saddlebag Grommets. Our products utilize the latest technology and high quality components to ensure you the most reliable service. We offer one of the best warranty programs in the industry and we back our products with excellent customer support, if you have questions before or during installation of this product please call Custom Dynamics® at 1(800) 382-1388.

Part Numbers: GROMMET-13 GROMMET-DC
GROMMET-14

Package Contents:

- Saddlebag Grommets (2)
- Instructions (1)

GROMMET-13 FITMENT:

2013-Earlier OEM Harley-Davidson® Saddle Bags with 1/8" Thickness.

GROMMET-14 FITMENT:

2014-2024 Harley-Davidson® Ultra Limited (FLHTK), 2014-2023 Street Glide (FLHX), Street Glide Special (FLHXS), 2015-2023 Road Glide (FLTRX), Road Glide Special (FLTRXS), 2017-2025 Road King Special (FLHRXS), 2014-2022 Road King (FLHR), 2022-2023 Street Glide ST (FLHXST), Road Glide ST (FLTRXST) & CVO™ Road Glide Limited (FLTRKSE), 2020-2024 Road Glide Limited (FLTRK), 2015-2022 CVO™ Street Glide (FLHXSE), 2018-2022 CVO™ Road Glide (FLTRXSE), 2019-2022 Electra Glide Standard (FLHT), 2014-2019 Electra Glide Ultra Classic (FLHTCU), 2015-2016 Ultra Classic Lo (FLHTCUL) & CVO™ Road Glide Ultra (FLTRUSE), 2016-2019 Road Glide Ultra (FLTRU), 2015-2018 Ultra Limited Lo (FLHTKL), 2014-2021 CVO™ Limited (FLHTKSE) and 2014 CVO™ Road King (FLHRSE).

Compatible with Custom Dynamics® LED Saddlebag Latch Lights with Red LEDs (3-wire) PN: 2040-2475/2040-2476/2040-2863/2040-2864/2040-2865/2040-2866 (sold separately).

GROMMET-DC FITMENT:

2014-2024 Harley-Davidson® Ultra Limited (FLHTK), 2014-2023 Street Glide (FLHX), Street Glide Special (FLHXS), 2015-2023 Road Glide (FLTRX), Road Glide Special (FLTRXS), 2017-2025 Road King Special (FLHRXS), 2014-2022 Road King (FLHR), 2022-2023 Street Glide ST (FLHXST), Road Glide ST (FLTRXST) & CVO™ Road Glide Limited (FLTRKSE), 2020-2024 Road Glide Limited (FLTRK), 2015-2022 CVO™ Street Glide (FLHXSE), 2018-2022 CVO™ Road Glide (FLTRXSE), 2019-2022 Electra Glide Standard (FLHT), 2014-2019 Electra Glide Ultra Classic (FLHTCU), 2015-2016 Ultra Classic Lo (FLHTCUL) & CVO™ Road Glide Ultra (FLTRUSE), 2016-2019 Road Glide Ultra (FLTRU), 2015-2018 Ultra Limited Lo (FLHTKL), 2014-2021 CVO™ Limited (FLHTKSE) and 2014 CVO™ Road King (FLHRSE).

Compatible with Custom Dynamics® LED Saddlebag Latch Lights with Dual Color LEDs (4-wire) PN: 2040-2845/2040-2846/2040-2847/2040-2848/2040-2867/2040-2868/2040-2869/2040-2870/2040-2871/2040-2872/2040-2873/2040-2874 (sold separately).



Installation:

1. Determine Saddlebag Grommet location.
2. Drill 9/16" hole at the determined Saddlebag Grommet location.
3. Insert the grommet into the pre-drilled 9/16" hole in Step 2.
4. Pull wire harness through Saddlebag Grommet.

Specifications:

Grommet-13

For Hole Diameter (A) 9/16"
For Material Thickness (B) 1/8"
ID (C) 1/8"
Flange Diameter (D) 3/4"
Overall Height (E) 1/4"

Grommet-14

For Hole Diameter (A) 9/16"
For Material Thickness (B) 1/4"
ID (C) 1/8"
Flange Diameter (D) 3/4"
Overall Height (E) 3/8"

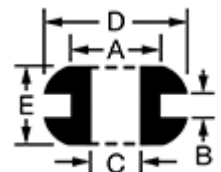

Grommet-DC

For Hole Diameter (A) 9/16"
For Material Thickness (B) 1/4"
ID (C) 3/16"
Flange Diameter (D) 3/4"
Overall Height (E) 3/8"



ATTENTION

Please read all information below before installation

Warning: Disconnect negative battery cable from the battery; refer to owner's manual. Failure to do so may result in electrical shock, injury, or fire. Secure negative battery cable away from positive side of battery and all other positive voltage sources on motorcycle.

Safety First: Always wear appropriate safety gear including safety glasses when performing any electrical work. It is highly recommended that safety glasses be worn throughout this installation process. Be sure motorcycle is on level surface, secure and cool.

Questions? Email: info@CustomDynamics.com or Call us at: 1 (800) 382-1388 M-TH 8:30AM-5:30PM / FR 9:30AM-5:30PM EST