



Custom Dynamics® Harley-Davidson® Wiring Adapter Installation Instructions

We thank you for purchasing the Custom Dynamics® Harley-Davidson® Wiring Adapter. Our products utilize the latest technology and highest quality components to ensure you the most reliable service. We offer one of the best warranty programs in the industry and we back our products with excellent customer support, if you have questions before or during installation of this product please call Custom Dynamics® at 1(800) 382-1388.

Part Numbers: MPR-BCM

Package Contents:

- HD BCM Harness Adapter (1)
- Instructions (1)

Fits: 2014-2024 Harley-Davidson® Ultra Limited (FLHTK), 2014-2023 Street Glide (FLHX), Street Glide Special (FLHXS), 2015-2023 Road Glide (FLTRX), Road Glide Special (FLTRXS), 2017-2025 Road King Special (FLHRXS), 2014-2022 Road King (FLHR), 2022-2023 Street Glide ST (FLHXST), Road Glide ST (FLTRXST) and CVO™ Road Glide Limited (FLTRKSE), 2020-2024 Road Glide Limited (FLTRK), 2015-2022 CVO™ Street Glide (FLHXSE), 2018-2022 CVO™ Road Glide (FLTRXSE), 2019-2022 Electra Glide Standard (FLHT), 2014-2019 Electra Glide Ultra Classic (FLHTCU), 2015-2016 Ultra Classic Lo (FLHTCUL) and CVO™ Road Glide Ultra (FLTRUSE), 2016-2019 Road Glide Ultra (FLTRU), 2015-2018 Ultra Limited Lo (FLHTKL), 2014-2021 CVO™ Limited (FLHTKSE), 2014 CVO™ Road King (FLHRSE).

Compatible with Custom Dynamics® Plug and Play Red Plasma Rods PN: 2040-2688/2040-2689/2040-2690/2040-2691 (**sold separately**), Antenna Plugz LEDs PN: 2040-2744/2040-2745/2040-2746/2040-2747 (**sold separately**) and Red Boltz PN: 2040-2838/2040-2839 (**sold separately**).



Installation:

1. Remove the seat and disconnect the negative battery cable from the battery.
2. Locate the connector for the rear harness under seat.
3. Unplug connector and plug inline the HD BCM Harness Adapter.
4. Connect wires as needed using Posi-Taps™.

Black - Ground

Blue - Running

Red - Brake

Brown - Right Turn/Brake

Violet - Left Turn/Brake

Orange - Aux Power

5. Reconnect the negative battery cable to the battery and reinstall the seat.
6. Test the rear lighting for proper operation.



ATTENTION



Please read all Information below before Installation

Warning: Disconnect negative battery cable from battery; refer to owner's manual. Failure to do so may result in electrical shock, injury, or fire. Secure negative battery cable away from positive side of battery and all other positive voltage sources on motorcycle.

Safety First: Make sure the motorcycle is parked on a level surface and motorcycles mechanical components are cool to the touch.

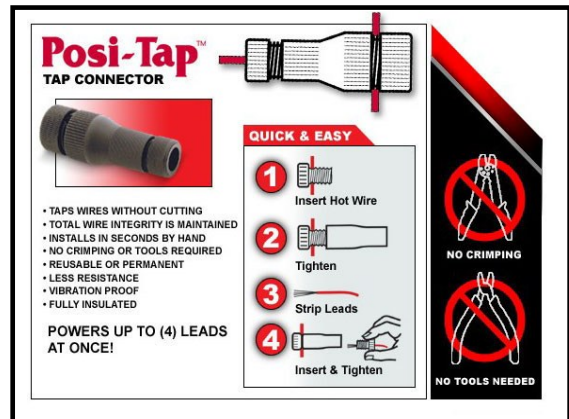

Questions? Email: info@CustomDynamics.com or Call us at: 1 (800) 382-1388 M-TH 8:30AM-5:30PM / FR 9:30AM-5:30PM EST