



## Custom Dynamics® ProBEAM® Amber/White ECE JAE Front Turn Signals Installation Instructions

We thank you for purchasing Custom Dynamics® ProBEAM® Amber/White ECE JAE LED turn signals! Our LED's offer maintenance free service and higher visibility. We offer one of the best warranty programs in the industry and we back our products with excellent customer support, if you have questions before or during installation of this product please call Custom Dynamics® at 1(800)382-1388. Patent Pending.

**Part Numbers:** PB-AW-ECE-JAE

US Patent: 830597, 830595

Chinese Patent: ZL201830045649.4, ZL201830045624.4

### **Package Contents:**

- ProBEAM® LED Clusters (1 pair)
- Smoked ProBEAM® Lenses (1 pair)

**Fits:** 2016-2023 Harley-Davidson® International (HDI) CVO™ model front turn signals. *Does not fit standard (non-CVO™) models. Does not fit US or Canadian models.*

**Important:** Road Glide models may need to have the front fairing removed to provide slack in the turn signal housing wiring and for running light connection.



## ATTENTION

Please read all information below before Installation

**Note:** Use care in removing the Stock LED bulbs from the housing, so as not to scratch or mar the chrome housing. Custom Dynamics® is not liable for damage to chrome during installation.

**Important:** This LED product is BCM compliant. It is recommended to run the 4 way hazard flashers for 3 minutes to allow the CanBus system to sync to the new load.



### **Installation:**

1. Remove the lens by inserting flat-blade screw driver in lens slot and gently twisting. See Photo 1.
2. Remove stock LED unit, apply light prying motions with screw driver or similar object around the perimeter of the light. It's easier if you can get in behind the gasket while doing this. Once enough of the light is out of the housing, pull it free, take care as the wiring is still attached. See Photo 2.

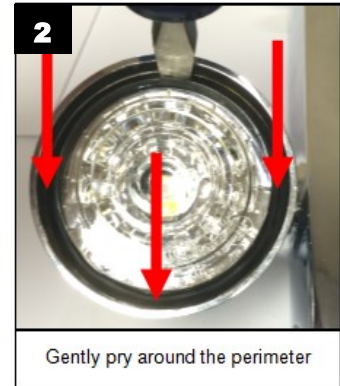

3. Locate the tab on the end of the wire connector, push in and disconnect the connector from the stock LED unit. See Photo 3.
4. Remove the turn signal LED and black gasket from the housing.



Questions? Email: [info@CustomDynamics.com](mailto:info@CustomDynamics.com) or Call us at: 1 (800) 382-1388 M-TH 8:30AM-5:30PM / FR 9:30AM-5:30PM EST

## Installation Instructions - Page 2

### Installation Continued:

5. Plug Replacement LED clusters into connector making sure they snap together. See Photo 4
6. Route the White single wire from the replacement LED cluster out of the Turn Signal Housing. See Photo 5.
7. Twist the Cluster a few revolutions to coil wiring.
8. Lay the cluster in the housing against the gasket, Make sure the cluster is level.
9. Install the lens with the notch facing downward, make sure it snaps in completely. The tabs on the lens will push the cluster snug against the gasket.
10. Connect the white wire to a fused switched power source or running light circuit.
11. Perform the LED Sync process:
  - Turn Ignition Power ON (do not start bike)
  - Turn 4 way Hazard flashers ON
  - Turn ignition power OFF
  - Let Hazard Flashers run for 3 minutes
  - Turn ignition power back ON
  - Turn 4 way Hazard Flashers OFF
12. Test Function of turn signals.

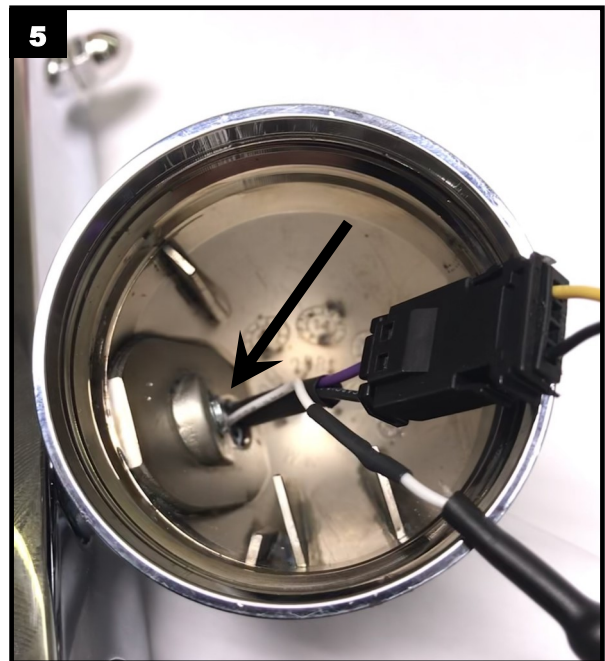
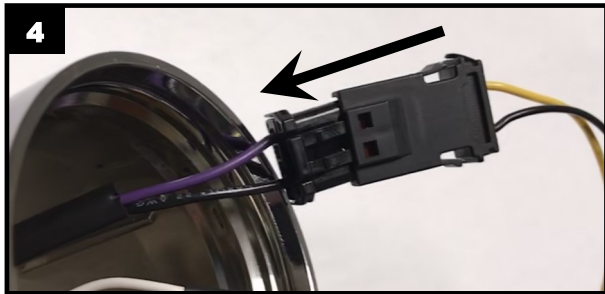

### **Caution:**

1. If there is a gap between the lens and the housing, water will leak into the unit and cause damage, be sure the lens is fully seated all the way around the perimeter.
2. Do not use the lens if any of the tabs are broken, doing so may cause water to enter the housing.
3. Do not install the lens without the ProBEAM lens gasket in place, doing so will cause water to leak into the housing.