

Custom Dynamics® ProBEAM® Dynamic Strips™ LED Turn Signals Installation Instructions



We thank you for purchasing the Custom Dynamics® ProBEAM® Dynamic Strips™ LED Turn Signals. Our products utilize the latest technology and high quality components to ensure you the most reliable service. We offer one of the best warranty programs in the industry and we back our products with excellent customer support. If you have questions before or during installation of this product please call Custom Dynamics® at 1(800) 382-1388.

Part Numbers: PB-DS2-13-B PB-DS2-13-C PB-DS2-13-CON

Package Contents:

- ProBEAM® Dynamic Strips™ LED Turn Signals (2)
- Y Adapter Harness (2)
- 4" Cable Ties (8)
- 5/16" x 1-1/4" Button Head Bolts (4)
- 5/16" Flat Washers (4)
- Instructions (1)

Fitment: 2006-2013 Harley-Davidson® Street Glide Models (Including CVO) and 2006-2013 Harley-Davidson® FLHT Models without driving light buckets.



Please read all Information below before Installation

Warning: Disconnect negative battery cable from battery; refer to owner's manual. Failure to do so may result in electrical shock, injury, or fire. Secure negative battery cable away from positive side of battery and all other positive voltage sources on motorcycle.

Safety First: Always wear appropriate safety gear including safety glasses when performing any electrical work. It is highly recommended that safety glasses be worn throughout this installation process. Be sure motorcycle is on level surface, secure and cool.

Note: When removing the OEM turn signals and replacing with LED's, you may experience a fast flashing and alarm code on your dash. If this occurs, our Signal Stabilizer™ is recommended. Contact us for details.

Cleaning: Take special care in cleaning the finish. Use only a non-abrasive cleaner and a fine microfiber cloth to remove dirt or debris. Never use abrasive polishes or cleaners as these can scratch the finish.

Installation:

1. Remove seat and disconnect the negative battery cable from the battery.
2. Remove the top three OEM T27 Torx screws from the outer fairing. Shown in **Figure 1**. Remove the windshield and store in safe place.



3. Reinstall the center OEM T27 Torx screw and lightly tighten to secure the outer fairing while removing the four remaining inner fairing screws to remove the outer fairing.
4. Remove the four screws, the two lower screws are located at the lower triple tree shown in **Figure 2 on Page 2**. The two upper screws are located near the speakers shown in **Figure 3 on Page 2**.

Questions? Email: info@CustomDynamics.com or Call us at: 1 (800) 382-1388 M-TH 8:30AM-5:30PM / FR 9:30AM-5:30PM EST

Installation Instructions - Page 2

Installation Continued:

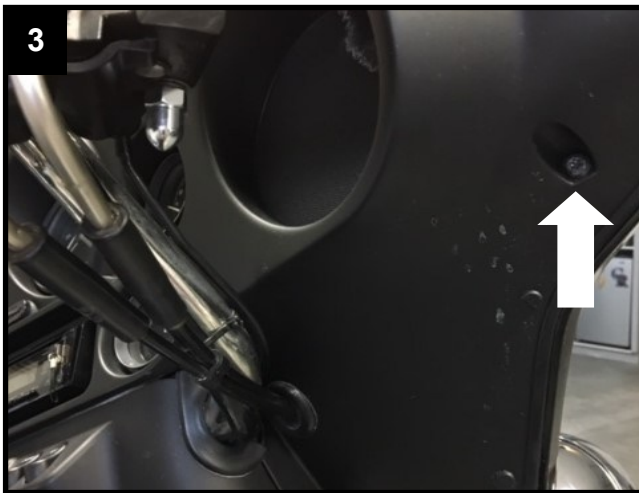

5. Remove the center OEM T27 Torx and remove the outer fairing and place in a safe place.
6. Remove all hardware that is holding the OEM turn signals to the forks and discard new hardware will be used.
7. Locate the OEM turn signal wiring connectors at the speaker support bracket. Shown in **Figure 4**.



8. Unplug the OEM turn signal wiring and remove the OEM turn signals from the motorcycle.
9. Plug in the supplied Y Adapter Harness into the turn signal wiring on the motorcycle both left and right.
10. Install both left and right ProBEAM® Dynamic Strips™ LED Turn Signals to the fork using the supplied 5/16" Button Head Bolts and Washers. **Note: The LED should be at the bottom of the ProBEAM® Dynamic Strips™ LED Turn Signals when mounted to the fork.**
11. Route the wiring of the ProBEAM® Dynamic Strips™ LED Turn Signals to the Y Adapter Harness and connect.
12. Use the supplied Cable Ties to secure the wires from being cut, frayed or pinched.
13. Reinstall the outer fairing and windshield in reverse order of removal.
14. Reconnect the negative battery cable to the battery and reinstall the seat.
15. Test the Custom Dynamics® ProBEAM® Dynamic Strips™ LED Turn Signals for proper operation.