

PROBEAM®

BY CUSTOM DYNAMICS®

ProBEAM® Eclipse® Module Installation Instructions

We thank you for purchasing the Custom Dynamics® Eclipse® Module. Our products utilize the latest technology and highest quality components to ensure you the most reliable service. We offer one of the best warranty programs in the industry and we back our products with excellent customer support. If you have questions before or during installation of this product please call Custom Dynamics® at 1(800) 382-1388.

Part Number: PB-EPZ

Package Contents:

- ProBEAM® Eclipse® Module (2)
- Instructions (1)

Fits: 2014-2022 Harley-Davidson® Road King (FLHR), 2014-2015 Limited CVO (FLHTKSE), 2015 Road Glide Ultra CVO (FLTRUSE), 2019-2022 Electra Glide Standard (FLHT), 2022-2023 Street Glide ST (FLHXST) and Road Glide ST (FLTRXST).

Compatible with ProBEAM® Saddlebag Lights and ProBEAM® Fillerz® (sold separately).

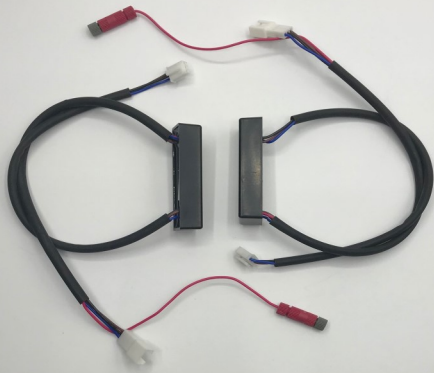

Figure 1

Installation:

1. Connect the male connector on the PB-EPZ to the female connector on the PB-FILL.
2. Connect the female connector on the PB-EPZ to the corresponding 3pin male connector on the MPR-BCM-PLUG 6 Pin Adapter. For the Right side use the 3pin connector with the Brown wire. For the Left side use the 3pin connector with the Purple wire.
3. Using a Posi-Tap™ Connector, connect the single RED wire on the PB-EPZ to the Red wire in the MPR-BCM-PLUG 6 Pin Adapter as shown in **Figure 2**.
4. Test running, brake, and turn functions.

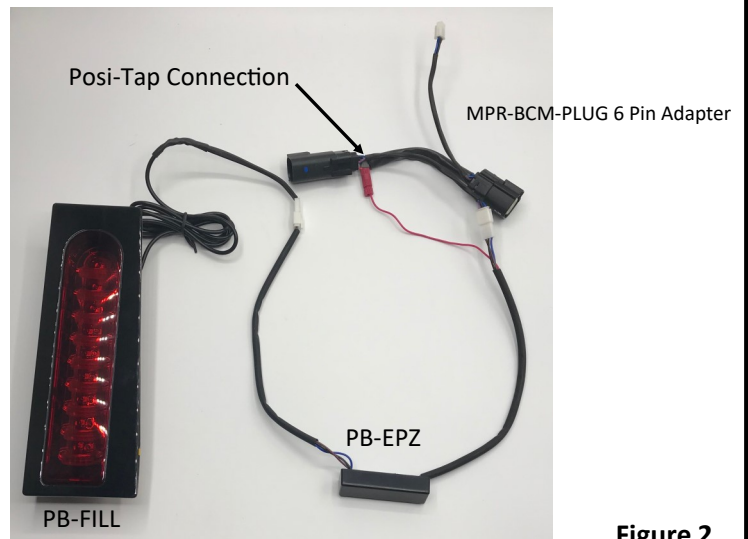

Figure 2



ATTENTION



Please read all Information below before Installation

Warning: Disconnect the negative battery cable from battery; refer to owner's manual. Failure to do so may result in electrical shock, injury or fire. Secure negative battery cable away from positive side of battery and all other positive voltage sources on vehicle.

Safety First: Make sure the bike is parked on a level surface and bike's mechanical components are cool to the touch.

Notice: Always wear appropriate safety gear including safety glasses when soldering or performing any electrical work. It is highly recommended that safety glasses be worn throughout this installation process. Read all directions before starting project.

NOTE: ProBEAM® Eclipse® Module is designed to be used exclusively with the ProBEAM® product line from Custom Dynamics®

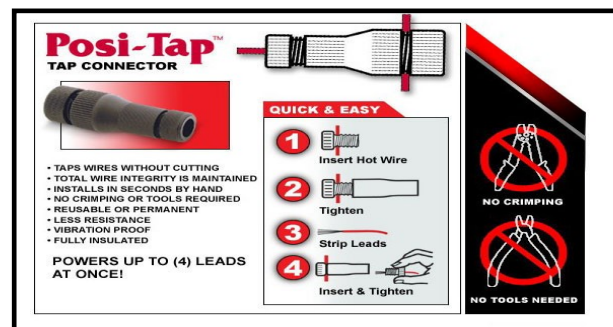

Questions? Email: info@CustomDynamics.com or Call us at: 1 (800) 382-1388 M-TH 8:30AM-5:30PM / FR 9:30AM-5:30PM EST