

Custom Dynamics® ProBEAM® LED Halo Fog Lamps Installation Instructions



We thank you for purchasing the Custom Dynamics® ProBEAM® LED Halo Fog Lamps. Our products utilize the latest technology and high quality components to ensure you the most reliable service. We offer one of the best warranty programs in the industry and we back our products with excellent customer support, if you have questions before or during installation of this product please call Custom Dynamics® at 1 (800) 382-1388.

Part Numbers: PB-FOG-BCM-B PB-FOG-BCM-C
PB-FOG-BCM-YB PB-FOG-BCM-YC

Package Contents:

- ProBEAM® LED Halo Fog Lamps (2)
- Wiring Harness (1)
- 6" Cable Ties (10)
- 6" Chrome Cable Ties (10)
- Instructions (1)

Fitment: 2014-2024 Harley-Davidson® Ultra Limited (FLHTK), 2014-2023 Street Glide (FLHX), Street Glide Special (FLHXS), 2015-2023 Road Glide (FLTRX), Road Glide Special (FLTRXS), 2017-2025 Road King Special (FLHRXS), 2014-2022 Road King (FLHR), 2022-2023 Street Glide ST (FLHXST), Road Glide ST (FLTRXST) & CVO™ Road Glide Limited (FLTRKSE), 2020-2024 Road Glide Limited (FLTRK), 2015-2022 CVO™ Street Glide (FLHXSE), 2018-2022 CVO™ Road Glide (FLTRXSE), 2019-2022 Electra Glide Standard (FLHT), 2014-2019 Electra Glide Ultra Classic (FLHTCU), 2015-2016 Ultra Classic Lo (FLHTCUL) & CVO™ Road Glide Ultra (FLTRUSE), 2016-2019 Road Glide Ultra (FLTRU), 2015-2018 Ultra Limited Lo (FLHTKL), 2014-2021 CVO™ Limited (FLHTKSE), 2014 CVO™ Road King (FLHRSE).

Compatible with mounting clamps PN: 2040-2345 and 2040-2346 (sold separately) or caliper mounts PN: 2040-3023 and 2040-3024 (sold separately).

Plug and play with Custom Dynamics® Auxiliary Switches PN: CD-AUX-UNV-B or CD-AUX-UNV-C (sold separately).



ATTENTION

Please read all information below before installation

Warning: Remove seat and disconnect the negative battery from the battery; Failure to do so may result in electrical shock, injury or fire. Secure negative battery cable away from positive side of battery and all other positive voltage sources on motorcycle.

Safety First: Make sure the motorcycle is parked on a level surface and motorcycle mechanical components are cool to the touch.

Note: Always wear appropriate safety gear including safety glasses when soldering or performing any electrical work. It is highly recommended that safety glasses be worn throughout this installation process. Please read all instructions before starting project.

Important: This product is designed and intended for use as auxiliary lighting only. It is **NOT** intended to replace any OEM lighting installed on the motorcycle and should **NOT** be used for that purpose.

Note: Mounting studs are 5/16" in diameter, please verify your mounting clamp hole before installation.

Note: Fog Lamps are set up to be mounted in a horizontal position. For vertical mounting (perpendicular to the ground) the optics will need to be rotated 90 degrees. Shown in **Figure 3 on Page 2** for mounting orientation. Scan the QR code in **Figure 3** for orientation instructions.



Installation:

1. Remove the seat and disconnect the negative battery cable from the battery.
2. Locate place to mount the ProBEAM® LED Halo Fog Lamps. For optimal performance, it is recommended the ProBEAM® LED Halo Fog Lamps be mounted horizontally on the outer most section of the engine guard by means of mounting clamp (sold separately). Shown in **Figure 1**.
3. Install the ProBEAM® LED Halo Fog Lamps mounting stud into the mounting clamp and secure the mounting clamp shown in **Figure 1**.



4. Route the wiring of the ProBEAM® LED Halo Fog Lamps back to the seat area by the battery. Use the supplied Cable Ties to secure the wiring from being cut, frayed or pinched. **Note:** When routing the wire, add a drip loop to prevent water from running back into the ProBEAM® LED Halo Fog Lamp. Shown in **Figure 2 on Page 2**.

Questions? Email: info@CustomDynamics.com or Call us at: 1 (800) 382-1388 M-TH 8:30AM-5:30PM / FR 9:30AM-5:30PM EST

Installation Instructions - Page 2

Installation Continued:

2

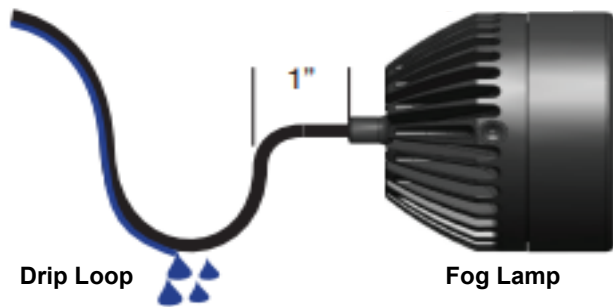

3

Mounting Orientation

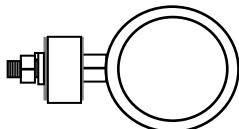

Horizontal

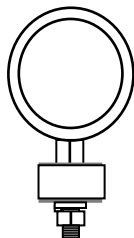

Vertical



SCAN ME

5. Disconnect the motorcycle's rear lighting harness at the battery area. Install the supplied Wiring Harness in-line with the rear lighting harness.
6. Mount the ON/OFF Switch, on the Wiring Harness in a convenient location with the installed double sided tape. Clean the location with denatured alcohol allow to dry 1-2 minutes.
Note: If using with Custom Dynamics® Auxiliary Switches, CD-AUX-UNV-B or CD-AUX-UNV-C (sold separately), refer to the instructions for that product.
7. Connect the wires from the individual ProBEAM® LED Halo Fog Lamp wiring harness.
8. Connect the battery lead from the Wiring Harness to the positive (+) battery terminal.
9. Reconnect the negative battery cable to the battery and reinstall the seat.
10. Test the new Custom Dynamics® ProBEAM® LED Halo Fog Lamps for proper operation. **Note: The ProBEAM® LED Halo Fog Lamps will always have a Halo running light on and when the ON/OFF Switch is ON both the Halo and ProBEAM® LED Halo Fog Lamp will be illuminated. CAUTION: ProBEAM® LED Halo Fog Lamps are HOT while in operation be careful not to burn hands.**