

## Custom Dynamics® ProGLOW™ Lower Fairing Inserts Installation Instructions



We thank you for purchasing the Custom Dynamics® ProGLOW™ Lower Fairing Inserts. Our products utilize the latest technology and high quality components to ensure you the most reliable service. We offer one of the best warranty programs in the industry and we back our products with excellent customer support, if you have questions before or during installation of this product please call Custom Dynamics® at 1(800) 382-1388.

**Part Numbers:** PG-LF

**Package Contents:**

- ProGLOW™ Lower Fairing Inserts (2)
- 6" Black Cable Ties (12)
- 7" Y Harness (1)
- Instructions (1)



**Fits:** 2014-2019 Harley-Davidson® Ultra Classic (FLHTCU), 2015-2016 Ultra Classic Low (FLHTCUL), 2014-2024 Ultra Limited (FLHTK), 2015-2019 Ultra Limited Low (FLHTKL), 2014-2021 CVO™ Ultra Limited (FLHTKSE), 2016-2019 Road Glide Ultra (FLTRU), 2020-2024 Road Glide Limited (FLTRK), 2015-2016 CVO™ Road Glide Ultra (FLTRUSE), 2022-2023 Road Glide Limited CVO™ (FLTRKSE), 2015-2019 Street Glide CVO™ (FLHXSE), 2014-2025 Tri Glide Ultra (FLHTCUTG) and 2020-2022 Tri Glide CVO™ (FLHTCUTGSE).

Replaces OEM 57100151 (Left) & 57100152 (Right). Also compatible on 2014-2023 Touring models with aftermarket Harley-Davidson® fairing lowers (57100257DH), Advanblack Rushmore Lower Vented Fairings and Saddle Tramp® Lower Fairing Speaker Assembly (Item# 2330-0248).

Requires ProGLOW™ Bluetooth controller PN: 2050-0440 (sold separately).

**Installation:**

1. Disconnect the negative battery cable from the battery.
2. Remove the grills from the Lower Fairings with a flat non marking tool.
3. Disconnect the large ProGLOW™ connector end from the Lower Fairing Light harness as shown in **Figure 1**.

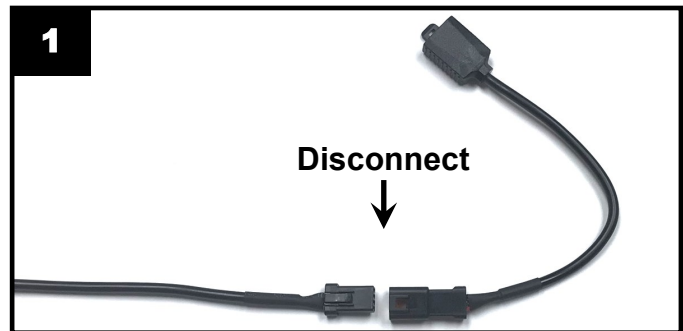

4. With the large connector end removed from the Lower Fairing wiring harness, route the Lower Fairing wiring harness through the front side of the Lower Fairing as shown in **Figure 2**.



# ATTENTION

Please read all Information below before Installation

**Warning:** Disconnect negative battery cable from battery; refer to owner's manual. Failure to do so may result in electrical shock, injury, or fire. Secure negative battery cable away from positive side of battery and all other positive voltage sources on motorcycle.

**Safety First:** Always wear appropriate safety gear including safety glasses when performing any electrical work. It is highly recommended that safety glasses be worn throughout this installation process. Be sure motorcycle is on level surface, secure and cool.

**Important:** This product is designed and intended for use as auxiliary lighting only. It is NOT intended to replace any original equipment lighting installed on the vehicle and should not be used for that purpose. This product must be wired so that it does not interfere with any original equipment lighting.

Questions? Email: [info@CustomDynamics.com](mailto:info@CustomDynamics.com) or Call us at: 1 (800) 382-1388 M-TH 8:30AM-5:30PM / FR 9:30AM-5:30PM EST

## Installation Instructions - Page 2

### Installation:

4. Gently pull back on the inside of the rear Lower Fairing cover and pull the Lower Fairing wiring harness through the lower Fairing. Shown in **Figures 3 and 4**.
5. If necessary, the 2 cover mounting screws can be removed from the back of the Lower Fairing to allow easier access. Shown in **Figure 5**.
6. Route the wiring harness of the lower fairing light back to the ProGLOW™ Bluetooth Controller. Route wires such that they not interfere with normal operation of the motorcycle.
7. Once wiring has been completed, secure any remaining wires with supplied Cable Ties from being cut, frayed or pinched.
8. Power the ProGLOW Bluetooth Controller (**sold separately**) OFF. Connect the lower fairing harnesses to Y harness. Now connect the Y harness to Channel 1 of the Controller. Use caution when connecting the mating ProGLOW™ Wheel Light connector, confirm the mating connector is connected correctly or damage will occur to the lighting accessories. The locking tab should slide onto the lock and lock into position. Shown in **Figure 6**.
9. Test the Custom Dynamics® ProGLOW™ Lower Fairing Inserts for proper operation.

