



## Custom Dynamics® Plug and Play Plasma Rod™ Adapter Installation Instructions

We thank you for purchasing the Custom Dynamics® Plug and Play Plasma Rod™ Adapter. Our products utilize the latest technology and high quality components to ensure you the most reliable service. We offer one of the best warranty programs in the industry and we back our products with excellent customer support, if you have questions before or during installation of this product please call Custom Dynamics® at 1(800) 382-1388.

**Part Numbers:** PR-MPRSEQ-BCM

### Package Contents:

- BCM Dual Color Plasma Rod™ Adapter w/ Plugs (1)
- Instructions (1)

**Fits:** 2014-2024 Harley-Davidson® Ultra Limited (FLHTK), 2014-2023 Street Glide (FLHX), Street Glide Special (FLHXS), 2015-2023 Road Glide (FLTRX), Road Glide Special (FLTRXS), 2017-2025 Road King Special (FLHRXS), 2022-2023 CVO™ Road Glide Limited (FLTRKSE), 2020-2024 Road Glide Limited (FLTRK), 2014-2019 Electra Glide Ultra Classic (FLHTCU), 2015-2016 Ultra Classic Lo (FLHTCUL), 2016 CVO™ Road Glide Ultra (FLTRUSE), 2016-2019 Road Glide Ultra (FLTRU), 2015-2018 Ultra Limited Lo (FLHTKL) and 2016-2021 CVO™ Limited (FLHTKSE).

Compatible with Custom Dynamics® Plug and Play Dual Color Plasma Rods PN: 2040-2702/2040-2703/2040-2704/2040-2705 (sold separately).



# ATTENTION

Please read all Information below before Installation

**Warning:** Disconnect negative battery cable from battery; refer to owner's manual. Failure to do so may result in electrical shock, injury, or fire. Secure negative battery cable away from positive side of battery and all other positive voltage sources on motorcycle.

**Safety First:** Always wear appropriate safety gear including safety glasses when performing any electrical work. It is highly recommended that safety glasses be worn throughout this installation process. Be sure motorcycle is on level surface, secure and cool.

**Important:** This product is designed and intended for use as auxiliary lighting only. It is NOT intended to replace any original equipment lighting installed on the vehicle and should not be used for that purpose. This product must be wired so that it does not interfere with any original equipment lighting.

**Note:** The BCM Plasma Rod™ Adapter must be plugged into the input side of any brake strobe modules.



### Installation:

1. Secure motorcycle on level surface. Remove seat and disconnect negative battery cable from the battery.
2. Locate and unplug the rear lighting harness connector to the rear fender.
3. Plug the supplied BCM Plasma Rod™ Adapter, in-line, into the rear lighting harness and into the motorcycles main wiring harness. **Note: The order of installation will be motorcycles BCM main wiring harness (Male Connector), BCM Plasma Rod™ Adapter, brake strobe module (if installed), and then the motorcycles rear lighting harness (Female Connector). Shown in Wiring Diagram on Page 2 for brake strobe modification.**
4. Connect the Plug and Play Plasma Rods™ (Sold Separately) to the installed BCM Plasma Rod™ Adapter. Connect Left Plasma Rod™ to the 4 pin connector of the BCM Plasma Rod™ Adapter with the violet wire. Connect Right Plasma Rod™ to the 4 pin connector of the BCM Plasma Rod™ Adapter with the brown wire. The single Red wire is only used for brake strobe function, Shown in **Wiring Diagram on Page 2.**
5. Secure wires under the seat to prevent the wires from being cut, frayed or pinched.
6. Reconnect the negative battery cable to the battery and reinstall the seat.
7. Test the Custom Dynamics® Plug and Play Plasma Rods™ for proper operation.

Questions? Email: [info@CustomDynamics.com](mailto:info@CustomDynamics.com) or Call us at: 1 (800) 382-1388 M-TH 8:30AM-5:30PM / FR 9:30AM-5:30PM EST

# Plug and Play Dual Color Plasma Rods™ Brake Strobe Modification

This modification will allow Plug and Play Dual Color Plasma Rods™ to strobe for brake when used with a MAGIC-STROBES-RSG module (Sold Separately).

The YELLOW jumper wire in the PRDC-MPR-BCM must be cut and capped. The long single Red wire will need to be connected to the brake output wire of the MAGIC-STROBES-RSG module.

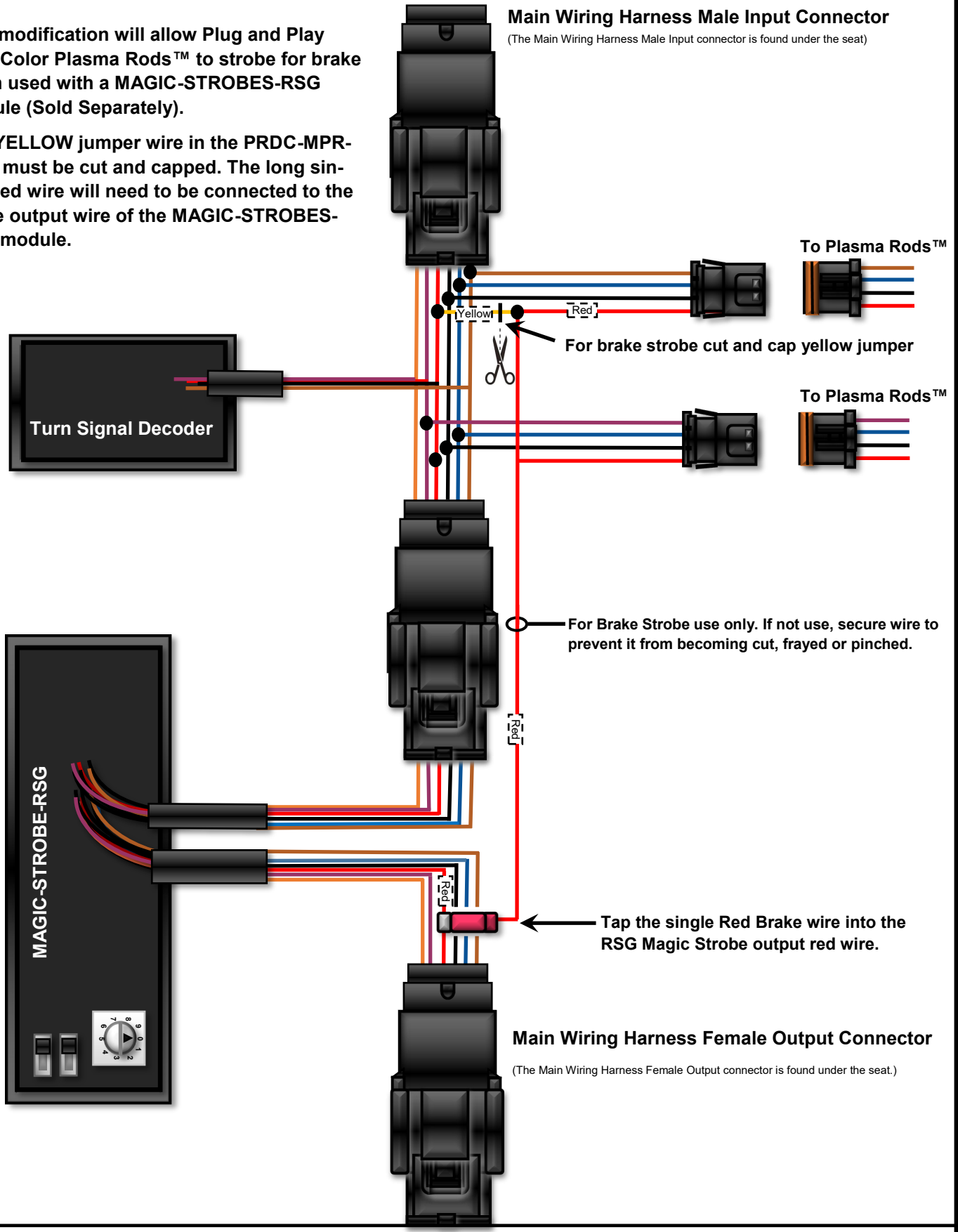

Questions? Email: [info@CustomDynamics.com](mailto:info@CustomDynamics.com) or Call us at: 1 (800) 382-1388 M-TH 8:30AM-5:30PM / FR 9:30AM-5:30PM EST