

Custom Dynamics® Shark Demon® Road Glide LED Turn Signals Installation Instructions



Part Numbers

Patent

SD-RG-FT-AW, SD-RG-FT-YB

US Patent: D1108671, China Patent: ZL202430646776.5

Package Contents

Shark Demon® LED Turn Signals (2)
5/16"-18 x 3/4" Socket Head Screws (2)
1/4"-20 x 1" Button Head Screws (2)
Thread Locker 0.5ml (1)
Instructions (1)

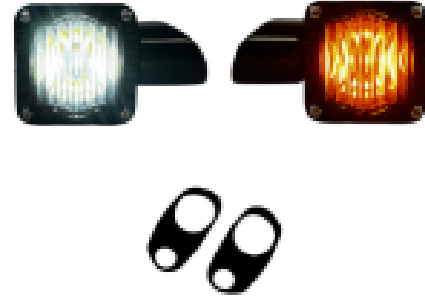

Fitment

2015-2023 Harley-Davidson® Road Glide (FLTRX), Road Glide Special (FLTRXS), 2022-2023 Road Glide ST (FLTRXST) & CVO™ Road Glide Limited (FLTRKSE), 2020-2024 Road Glide Limited (FLTRK), 2018-2022 CVO™ Road Glide (FLTRXSE), 2016-2019 Road Glide Ultra (FLTRU), 2020-2022 CVO™ Road Glide Ultra (FLTRUSE) and 2023-2025 Road Glide 3 (FLTRT).

Suggested Tools

Safety Glasses
Front Fender Protection
T-25 TORQ Socket or Handle Driver
T-27 TORQ Socket or Handle Driver
T-30 TORQ Socket or Handle Driver
3/16" Allen Socket or T-Handle
1/4" Allen Socket or T-Handle
5mm Allen Socket or T-Handle
10mm Socket or Open End Wrench
Phillips Screwdriver

Installation

[Click Link for Install Video](#)

[Click Here](#)

Warning

Rider and passenger safety depend upon the correct installation of this kit. Use the appropriate service manual procedures. If the procedure is not within your capabilities or you do not have the correct tools, have a qualified technician perform the installation. Improper installation of this kit could result in death or serious injury.

1. Remove all necessary parts to disconnect the negative battery cable from the battery.
2. Remove the 4 windshield screws shown in **Figure 1**. Lift windshield up to remove and store windshield in a safe place to prevent damage.
3. Remove the vent by pulling straight up on the vent shown in **Figure 2**. The vent is held in place with clips and will pop off. Store in a safe place to prevent damage.
4. Locate and disconnect the left and right OEM turn signal harness JAE connectors shown in **Figure 3**.

Questions? Email: Info@CustomDynamics.com or Call us at: 1(919)554-0949 M-TH 8:30AM-5:30PM, F 9:30AM-5:30PM EST

Installation Instructions Continued - 2

5. Remove the socket head screws at the left and right turn signals with a 3/16" Allen wrench shown in **Figure 4**.
6. Remove left and right side lower air deflector T25 Torx bolts shown in **Figure 5**.
7. Remove left and right speaker grills. The speaker grills are held in place by clips. Remove by pushing outwards from the inside of the speaker grills shown in **Figure 6**.
8. Remove left and right side T30 Torx bolts in the corner of speaker housing shown in **Figure 7**. Once bolts are removed the outer fairing can be removed and placed on a bench.
9. Remove the left and right turn signals from fairing by removing the 1/4" Allen socket screws shown in **Figure 8**.

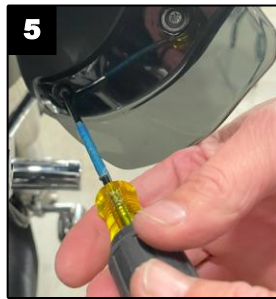
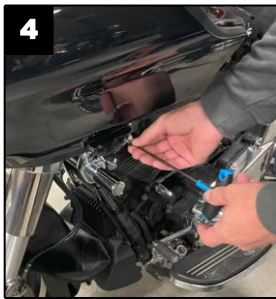
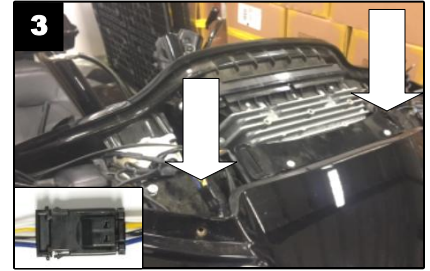

Notice

Hand start all bolts, **DO NOT** use impact wrench/"zip gun" when installing.

10. Install the new left and right Shark Demon® Road Glide® LED Turn Signals and Gaskets by routing the wire and plug through the hole in the fairing and through the clip.
11. Align the locating pin on the backside of the Shark Demon® Road Glide® LED Turn Signal with the hole on the plastic mount. Place a drop of supplied Thread Locker on threads of supplied 5/16"-18 Socket Head Screw, tighten securely. Route turn signal wire up the same way as the OEM turn signal wire.
12. Reinstall fairing in reverse order in which it was removed.
13. Connect left and right turn signal JAE connectors
14. Reinstall speaker grills, vent, and windshield in reverse order in which they were removed.
15. Reconnect the negative battery cable to the battery and reinstall all necessary parts.
16. Test the new Custom Dynamics® Shark Demon® Road Glide® LED Turn Signals for proper operation.

Cleaning Warning

Never use abrasive polishes or cleaners (e.g. "bug off" cleaners) as these can scratch and/or damage the finish, voiding warranty coverage. Avoid power washing/applying direct stream to aftermarket parts.

Questions? Email: Info@CustomDynamics.com or Call us at: 1(919)554-0949 M-TH 8:30AM-5:30PM, F 9:30AM-5:30PM EST