



Custom Dynamics® TruFLEX® Integrated Plate Frame Installation Instructions

We thank you for purchasing the Custom Dynamics® TruFLEX® Integrated Plate Frame. Our products utilize the latest technology and high quality components to ensure you the most reliable service. We offer one of the best warranty programs in the industry and we back our products with excellent customer support, if you have questions before or during installation of this product please call Custom Dynamics® at 1(800) 382-1388.

Part Number: TF05-BMC-B TF05-BCM-C

Package Contents:

- TruFLEX® License Plate Frame w/ Converter (1)
- Mounting Hardware Kit (1)
- BCM Y-Adapter (1)
- 4" Cable Ties (10)
- Instructions (1)



Fits: 2014-2024 Harley-Davidson® Ultra Limited (FLHTK), 2014-2023 Street Glide (FLHX), Street Glide Special (FLHXS), 2015-2023 Road Glide (FLTRX), Road Glide Special (FLTRXS), 2017-2025 Road King Special (FLHRXS), 2022-2023 CVO™ Road Glide Limited (FLTRKSE), 2020-2024 Road Glide Limited (FLTRK), 2014-2019 Electra Glide Ultra Classic (FLHTCU), 2015-2016 Ultra Classic Lo (FLHTCUL), 2016-2019 Road Glide Ultra (FLTRU), 2015-2018 Ultra Limited Lo (FLHTKL), 2016 CVO™ Road Glide Ultra (FLTRUSE) and 2016-2021 CVO™ Limited (FLHTKSE).

Note: Radius License Plate Frame Mount required for installation (sold separately).

Installation:

1. Remove seat and disconnect the negative battery cable from the battery.
2. Locate and unplug the lighting connector for the rear fender. Shown on **Page 3**.
3. Plug the supplied BCM Y-Harness Adapter in-line with the rear lighting harness and the motorcycles main wiring harness. **Note: If installing with Magic Strobe RSG Module, refer to the RSG modification diagram on Page 2.**
4. Mount the TruFLEX® License Plate Frame using the supplied Hardware Kit. **Note: For proper fitment the license plate may need to be cut or notched to allow the wiring from the TruFLEX® License Plate Frame to pass through.**
5. Route the wiring from the TruFLEX® License Plate Frame to the BCM Y-Harness. Secure wires with supplied Cable Ties to prevent the wires from being cut, frayed or pinched.
6. Connect the TruFLEX® License Plate Frame left side (violet) wire and right side (brown) wire to the BCM Y-Harness connectors.
7. Reconnect the negative battery cable to the battery and reinstall the seat.
8. Test the new Custom Dynamics® TruFLEX® License Plate Frame for proper operation. **Note: If you're experiencing a Rapid Flash in the dash turn signal indicators you must perform a BCM Sync. To perform a BCM Sync, turn ignition ON and turn on 4 way hazards and count 10 flashes and deactivate. Turn on 4 way hazards for another 10 flashes and deactivate. Turn ignition OFF then back ON, turn on 4 way hazards for 10 flashes and deactivate. After performing the BCM Sync the turn signal dash indicators should no longer be Rapid Flashing.**



ATTENTION

Please read all Information below before Installation

Important: Disconnect the negative battery cable from the battery; Failure to do so may result in electrical shock, injury or fire. Secure negative battery cable away from positive side of battery and all other positive voltage sources on motorcycle.

Important: For safety make sure the motorcycle is parked on a level surface motorcycles mechanical components are cool to the touch.

Note: Always wear appropriate safety gear including safety glasses when soldering or performing any electrical work. It is highly recommended that safety glasses be worn throughout this installation process. Please read all instructions before starting project.

Note: For proper fitment, the license plate may need to be cut or notched to allow the wiring from the license frame to pass through.

Important: This product is intended for use as auxiliary lighting only. Not intended to replace OEM lighting installed on the motorcycle and should not be used for that purpose. This product must be wired so that it does not interfere with any OEM lighting.

Questions? Email: info@CustomDynamics.com or Call us at: 1 (800) 382-1388 M-TH 8:30AM-5:30PM / FR 9:30AM-5:30PM EST

Installation Instructions - Page 2

This modification will allow Sequential Saddle Bags to strobe for brake when used with a MAGIC-STROBES-RSG module (Sold Separately).

The YELLOW jumper wire in the BCM Adapter Harness must be cut and capped. The long single Red wire will need to be connected to the brake output wire of the MAGIC-STROBES-RSG module.

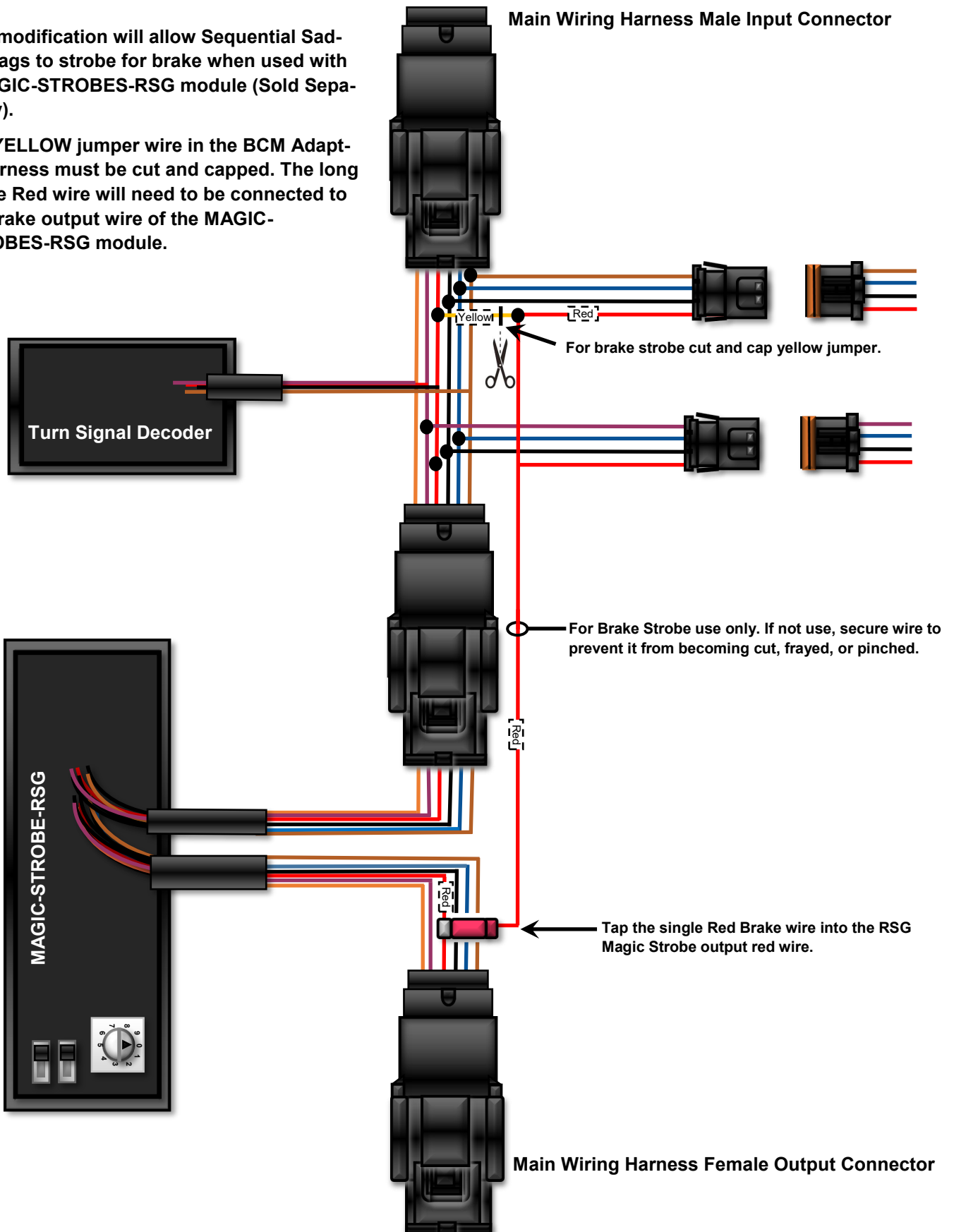

Installation Instructions - Page 3

Harness Connector Location—Top Rear Fender



For: Road King, Electra Glide Ultra Classic, Electra Glide Ultra Classic Lo, Electra Glide Ultra Limited, Electra Glide Ultra Limited Lo, Road Glide Ultra CVO

Harness Connector Location—on top of ECM



For: Road King CVO, Street Glide CVO