



Custom Dynamics® CVO Tri Glide Taillight Adapter Installation Instructions

We thank you for purchasing the Custom Dynamics® CVO Tri Glide Taillight Adapter. Our products utilize the latest technology and highest quality components to ensure you the most reliable service. We offer one of the best warranty programs in the industry and we back our products with excellent customer support, if you have questions before or during installation of this product please call Custom Dynamics® at 1(800) 382-1388.

Part Number: TL-ADPT

Package Contents:

- CVO Tri Glide Taillight Adapter (1)
- Instructions (1)

Fits: 2020-2022 Harley-Davidson® CVO Tri Glide (FLHTCUTGSE).

Note: Compatible with Custom Dynamics® LED Taillights (sold separately).



ATTENTION



Please read all Information below before Installation

Warning: Disconnect the negative battery cable from battery; refer to owner's manual. Failure to do so may result in electrical shock, injury or fire. Secure negative battery cable away from positive side of battery and all other positive voltage sources on the motorcycle.

Safety First: Always follow the basic safety guidelines while working. Park the motorcycle on a flat level surface and make sure ignition is off.



Installation:

1. Disconnect the negative battery cable from the battery.
2. Remove the OEM taillight from the motorcycle by removing the two screws, save for reuse.
3. Connect Custom Dynamics® CVO Tri Glide Taillight Adapter to the Custom Dynamics® LED Taillight (sold separately). Shown in **Figure 1**.

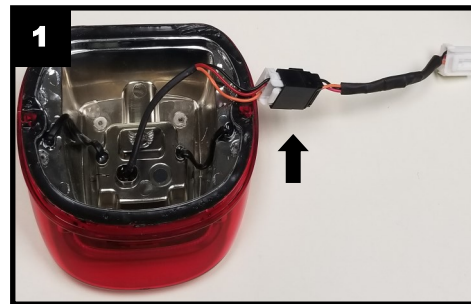

4. Connect the Custom Dynamics® CVO Tri Glide Taillight Adapter to the circuit board. Shown in **Figure 2**.



5. Install Custom Dynamics® LED Taillight (sold separately).
6. Reconnect the negative battery cable to the battery.
7. Test rear taillight for proper operation.

Questions? Email: info@CustomDynamics.com or Call us at: 1 (800) 382-1388 M-TH 8:30AM-5:30PM / FR 9:30AM-5:30PM EST